

MP-X-T0-01

Semi Portable X System - “THEONE” Drinking fountain and bottle refill

Instruction Book



DISCLAIMER AND SAFETY

Here at Meet PAT™ we are very safety conscious. We design and manufacture water related products with the safety of you, the user, foremost in mind. In addition, we ask that you exercise a degree of care when using any Meet PAT™ product.

IMPORTANT SAFEGUARDS FOR YOUR MEET PAT UNITS

- Carefully read all instructions before operation and save them for future reference.
- Find a suitable, stable location for the units.
- Do not set the units up near live exposed electrical connections or wiring.
- Check the quality and potability of the water source and that there is correct pressure.
- Set up all connections before turning on the water supply.
- Once the water supply is turned on check each unit's connections for leakages. If a leakage is found turn off the water supply and remove the pressure from the units by pressing the refill buttons. Unplug the leaking connection and check for damage or dirt. Do not use if any leaks are prevalent.
- Units can be heavy to install, use the appropriate number of people and equipment.
- Ensure the units are regularly cleaned and serviced.
- If applicable, ensure the water filters are replaced as required.

Meet PAT™ takes no responsibility for suitability of install location, clearance for traffic, pedestrians or other clearance requirements. Meet PAT™ recommends that the chosen locations are reviewed for OHS and suitable other parties (including council) to ensure compliance. Meet PAT™ takes no responsibility for the structural integrity of the mounting surface chosen and recommends consultation with an engineer or suitable other parties prior to mounting.

For individual material, component or further installation details, please contact Meet PAT™ sales. Meet PAT units have a maximum working pressure of 6 bar - 600kpa (87 psi/ 0.6MPa). Customer or installer to check water pressure and install pressure relief valve on supply side if required.

Meet PAT™ products must be installed in accordance with the provisions of AS/NZS3500 and any relevant local regulations. Installations not complying with AS/NZS3500 may void the product and performance warranty provisions.

All recommendations within this document should be used as a guide only. Users and installers should seek suitable assistance to ensure units comply with all standards and are safe for use.

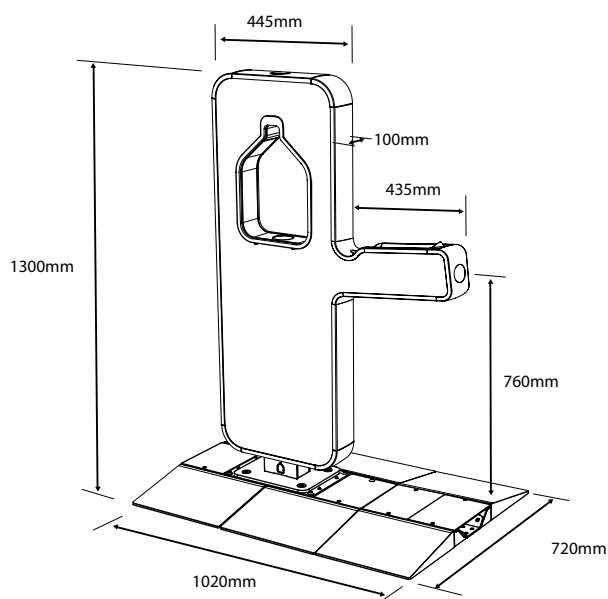

MP-X_TO_01

REGULAR

Indoor/Outdoor	Suitable for both indoor and outdoor applications.
Weight	55kg
Tapware/Push Buttons	316 stainless steel Easy-press stainless steel buttons.
Chassis	Aluminium and galvanised mild steel
Graphics Panels	Polycarbonate. Custom printing supplied as standard.
Nozzle	316 stainless steel
Water Pressure	Max. 600kpa operating pressure
Filter	5 micron carbon filter
Flow Rate	5L per minute (pressure dependent)
Power	None
Flow Meter	Digital in litres
Minimum Working Temp	1°C
Warranty	1 Year (refer to Meet PAT warranty documentation for details)

Meet PAT™ products must be installed in accordance with the provisions of AS/NZS3500 and any relevant local regulations. Installations not complying with AS/NZS3500 may void the product and performance warranty provisions. All information and images contained in the document are © Meet PAT™ - Products and Things Pty Ltd (as a trustee for Meet Pat Unit Trust) or their respective owners. They are not to be used without consent from Meet PAT™. As improvements in the design and performance of Meet PAT products are continuous, specifications may be subject to change without notice. This technical sheet is copyright and owned by Meet PAT™ - Products and Things Pty Ltd (as a trustee for Meet Pat Unit Trust) ABN 42634465637. All rights are reserved.

"X" SYSTEM - BASE ASSEMBLY

Here at Meet Pat we are very safety conscious. We design and manufacture water related products with the safety of you, the user, foremost in mind.

In addition, we ask that you exercise a degree of care when using any Meet PAT product and adhere to a common sense approach.

- Do not set the units up near live exposed electrical connections or wiring.
- Do not set up in high wind areas.
- If the hoses pass over traffic areas use approved hose trip covers.

Please refer to our website www.meetpat.com.au for full safety, setup and warranty info.

* Base Assembly components

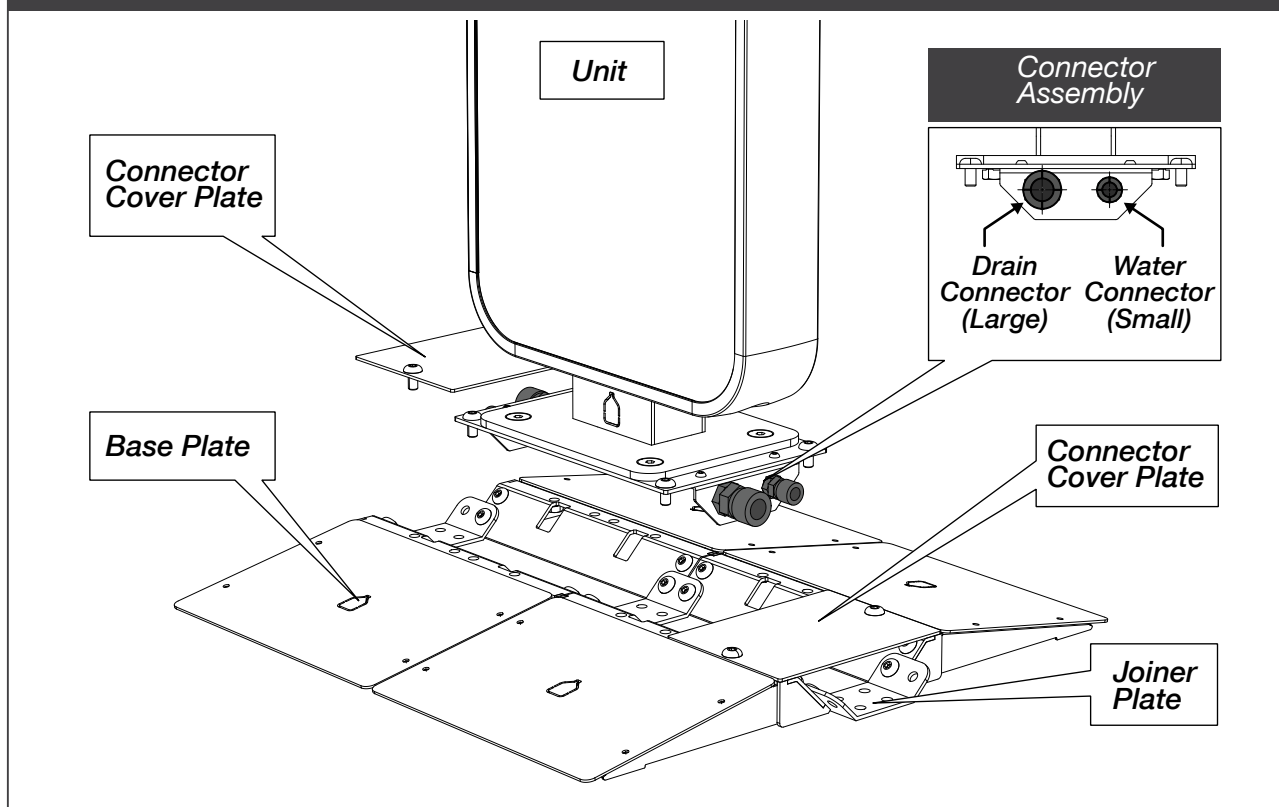

* Components supplied with each unit

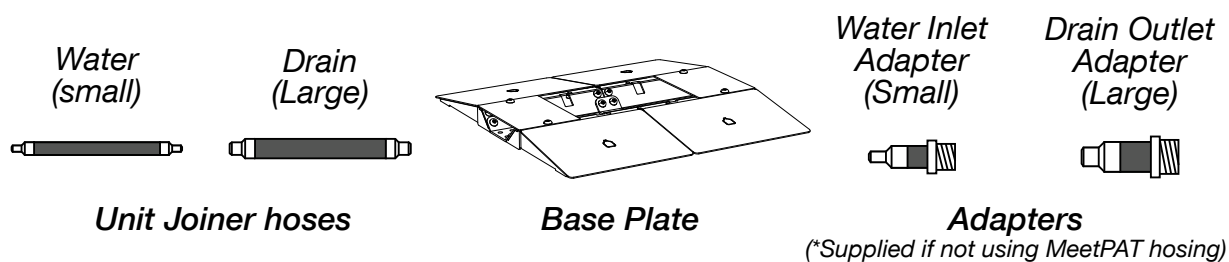

"X" SYSTEM - SETUP

1

* Remove the connector cover plates from the Base plate.

*Remove the cover plates completely and set aside.

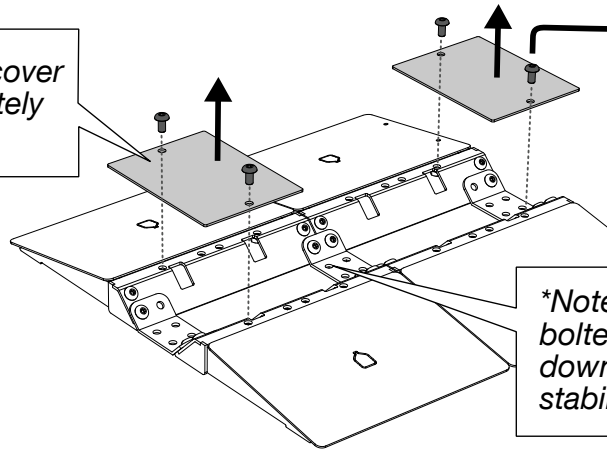

*Note: Unit can be bolted or pegged down for added stability

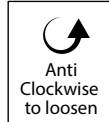

2

* Add as many base plates side by side as needed.

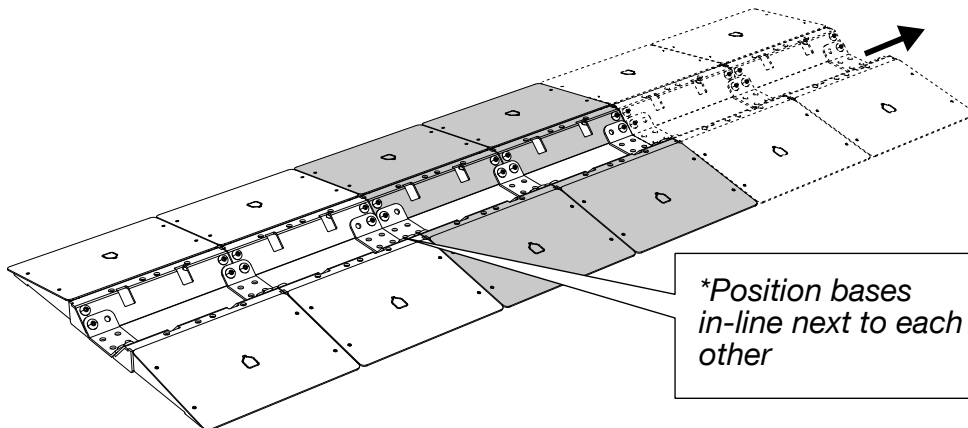

*Position bases in-line next to each other

3

*Remove the two mating joiner plates and place aside.

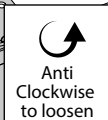

4

*Add 1 joiner plate across the joint. Bolt the two bases together.

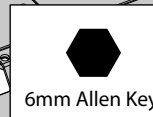

X 4
M10
Screws

"X" SYSTEM - SETUP

5

* Bolt the unit to the base plate using the 4 x M10 bolts supplied

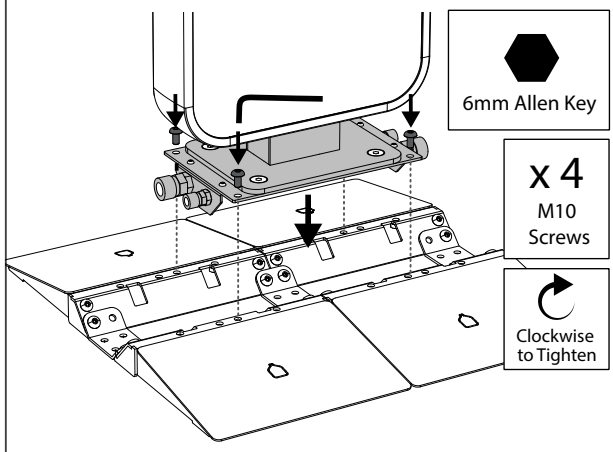

6

* If setting up multiple units bolt the remaining units to the bases.

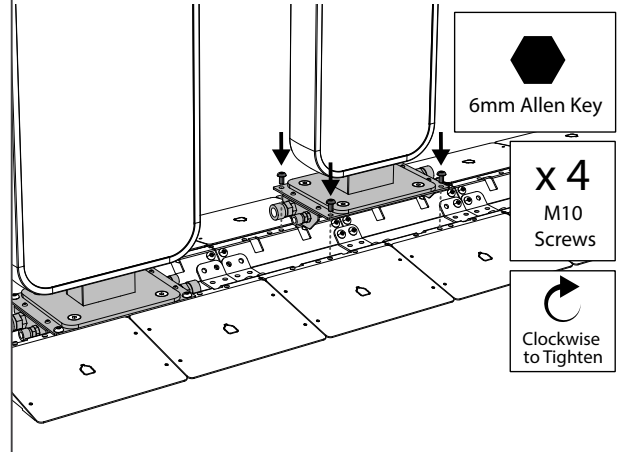

7

* Connect the Water inlet adapter to a drink safe approved hose.

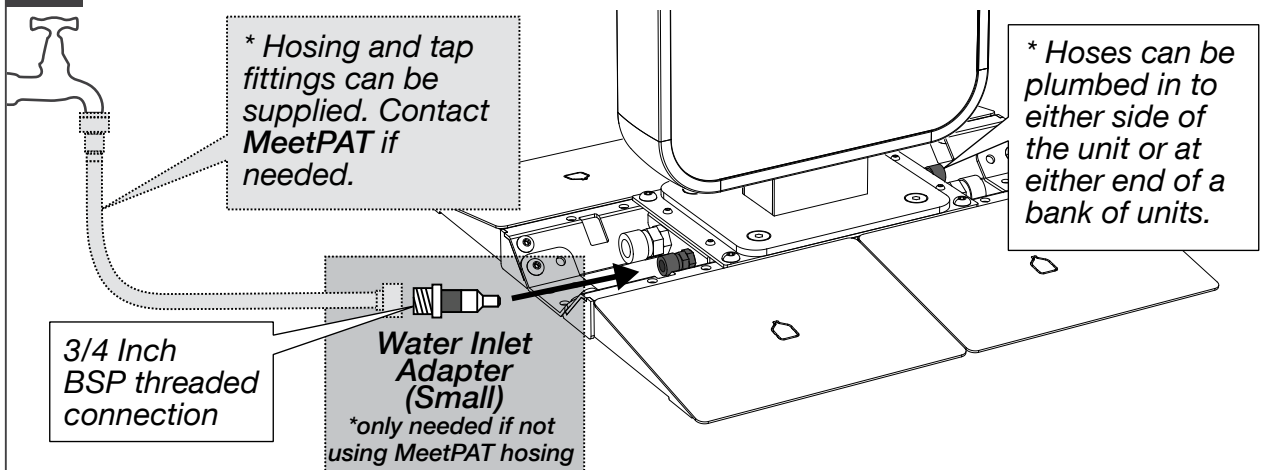

8

a Pull back the connector cover and hold in place.

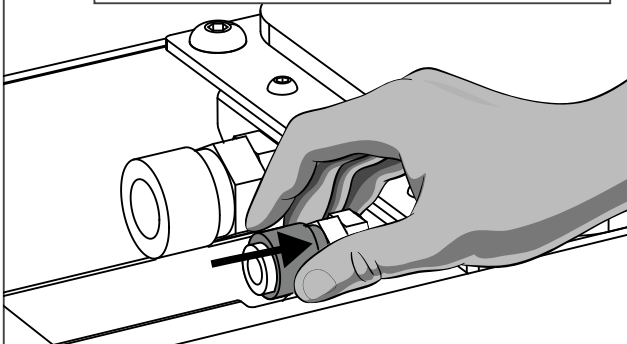

* Note: Water inlet - Small connector

8

b Insert the adapter into the connector. Release the connector cover to lock the connection in place.

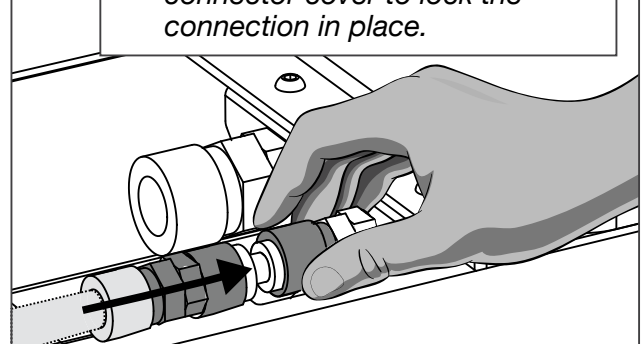

* Note: Water inlet - Small connector

"X" SYSTEM - SETUP

9

* Connect the **Drain Outlet** adapter to an appropriate hose.

* Hosing and fittings can be supplied. Contact **MeetPAT** if needed.

3/4 Inch BSP threaded connection

Water Outlet Adapter (Large)

*only needed if not using MeetPAT hosing

* Drain water into a suitable area

* Hoses can be plumbed in to either side of the unit or at either end of a bank of units.

10

a Pull back the connector cover and hold in place.

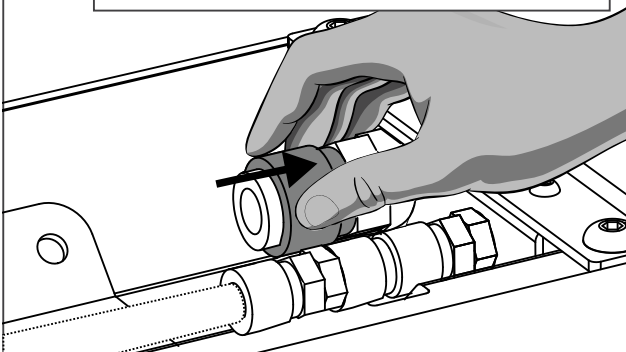

* Note: Drain outlet - Large connector

10

b Insert the adapter into the connector. Release the connector cover to lock the connection in place.

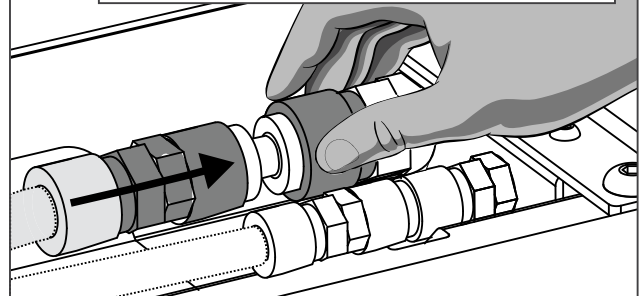

* Note: Drain outlet - Large connector

11

* To connect **multiple units together** - Use the **joiner hoses** supplied to connect the **Water Inlet** and **Drain Outlet** together.

Water Inlet Joiner hose (small)



Drain Joiner hose (Large)



* Continue to link the remaining units together

* Note: Water inlet - Small connector
Drain outlet - Large connector

"X" SYSTEM - SETUP

12

* Check for water quality and taste

* Before connecting into a potable water source make sure the water pressure is not above 600kpa.

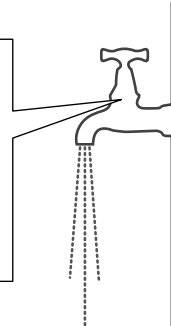

13

* Turn on the water supply

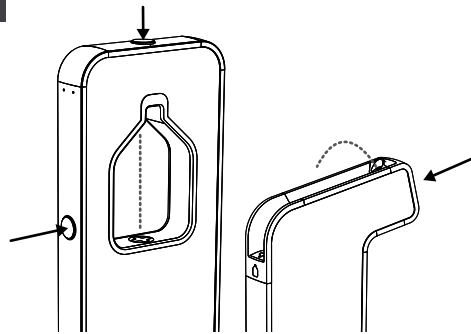

* Press all the taps for 10 seconds to flush out, air and old water in the lines. Check for leaks. If a leak is found turn off the water and check connections.

14

* Bolt down the cover plates over the connectors.

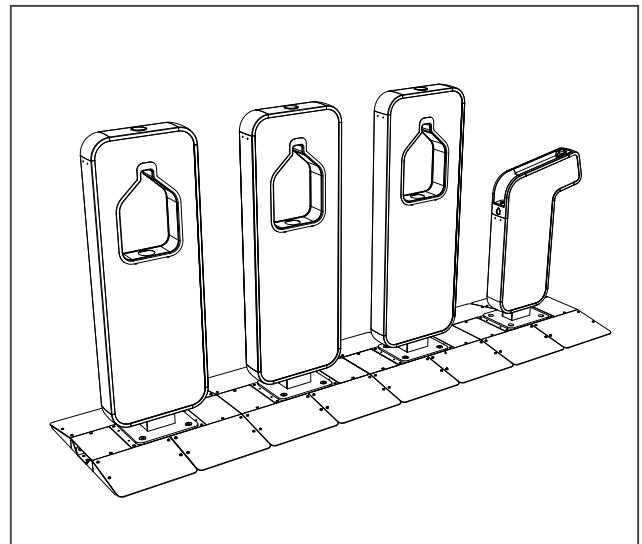
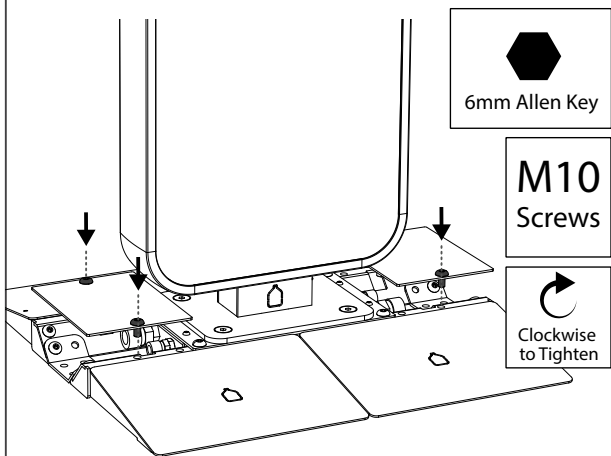

PANEL REPLACEMENT

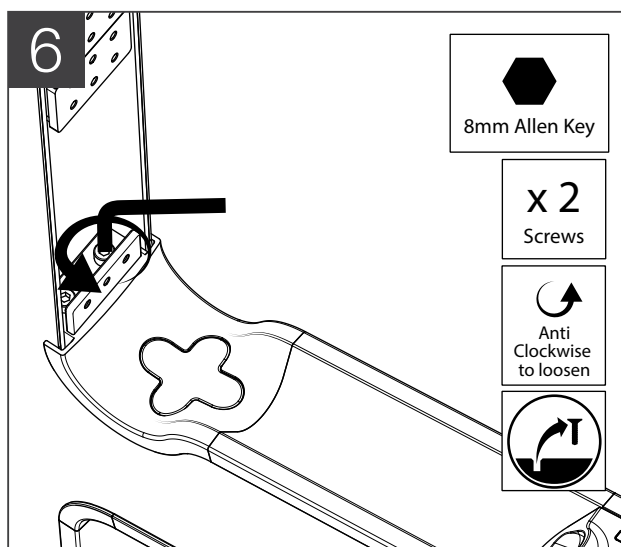
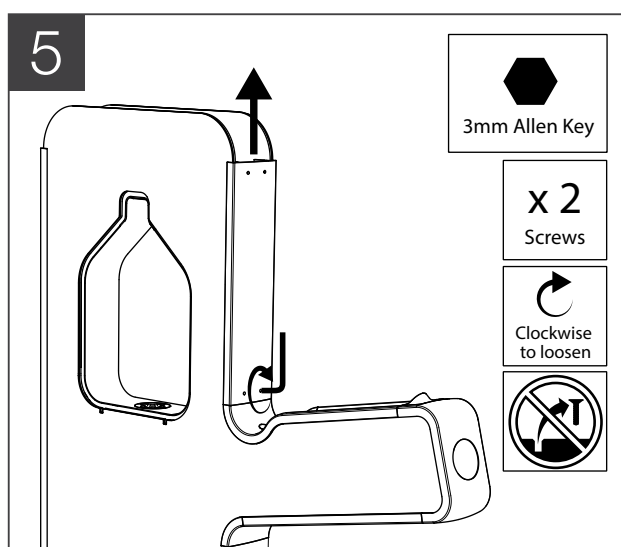
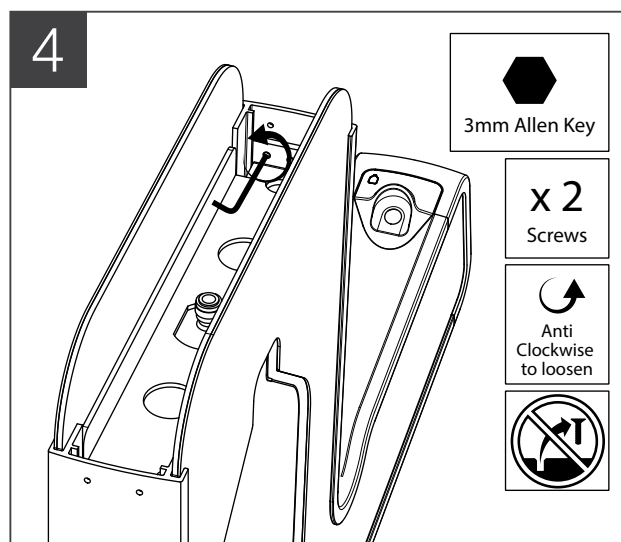
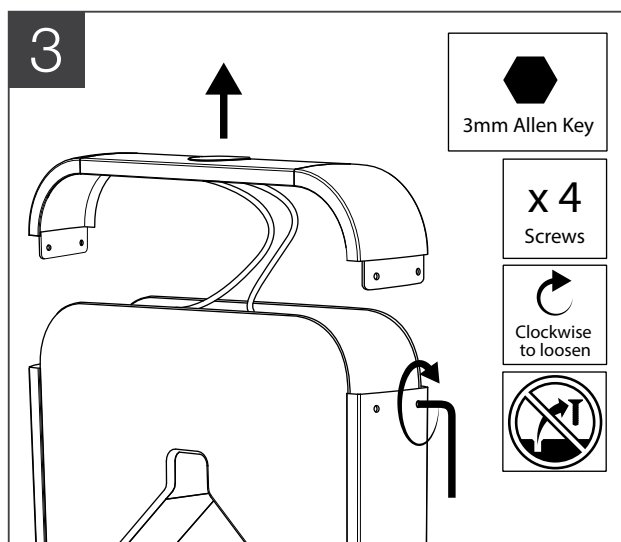
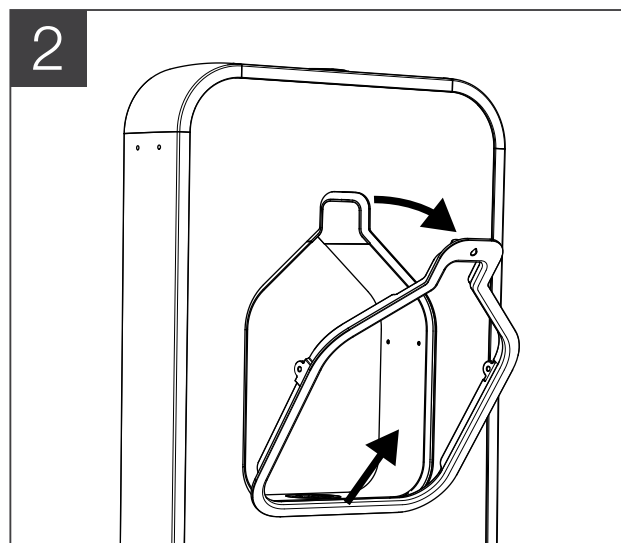
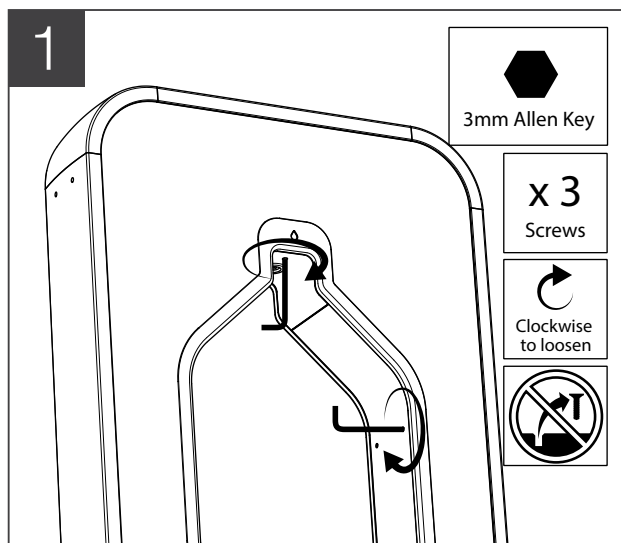

PANEL REPLACEMENT

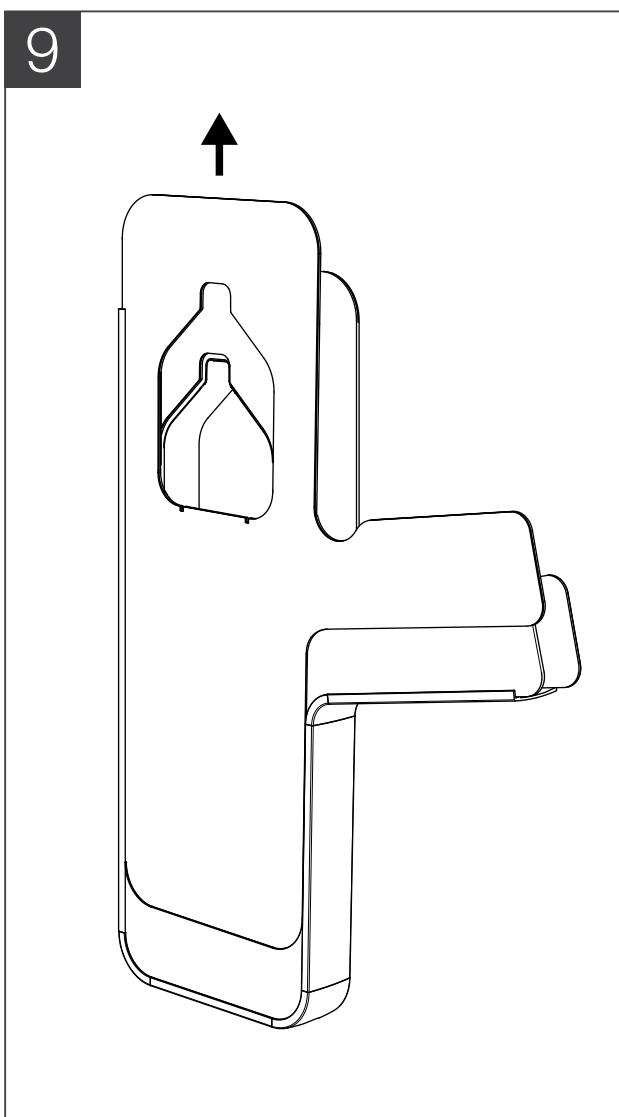
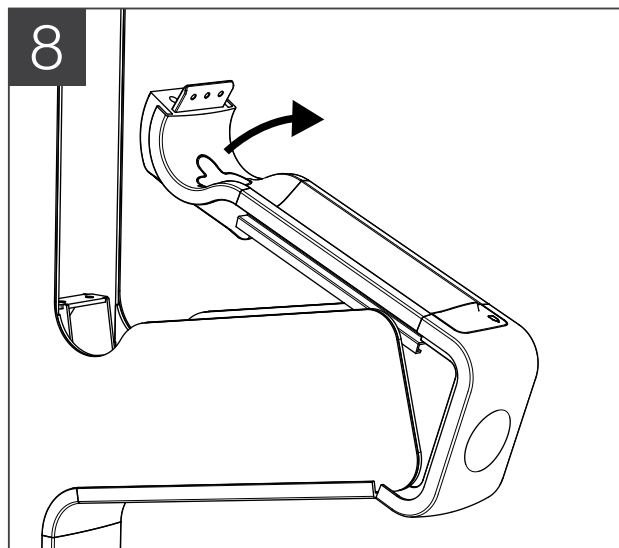
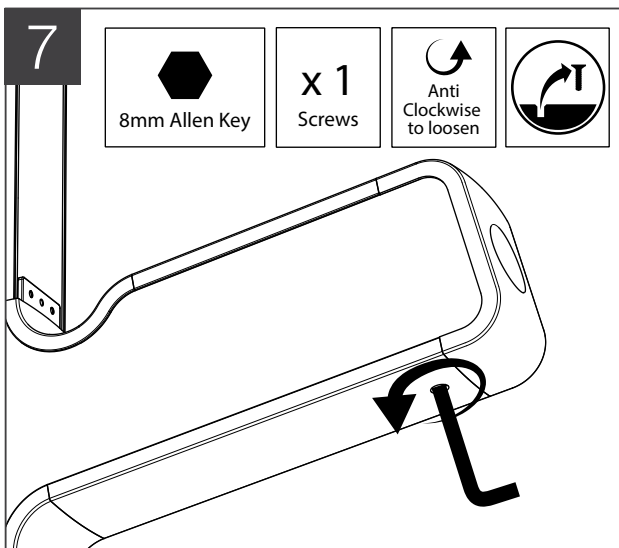

Putting it back together

All finished and need to put the unit back together?

Follow the steps in reverse

9,8, → 4,3,2,1

** Remember to reattach any water pipes disconnected during disassembly.*



Only 3-4 turns to loosen do not unscrew completely.

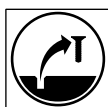

Remove screw completely.

FILTER REPLACEMENT

! Disconnect water supply

Disconnect or turn off the water supply.
De-pressure the unit by pushing the buttons.

1 *Once a panel has been removed. Locate the filter inside the unit

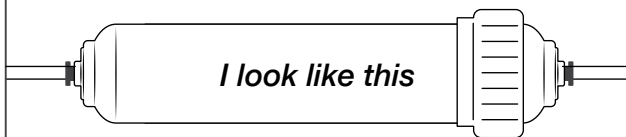

2

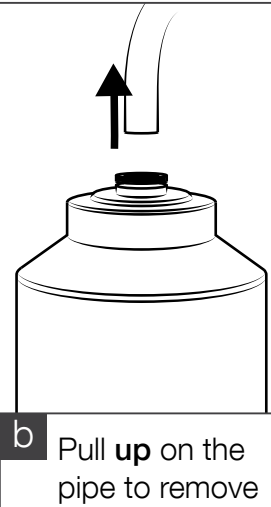
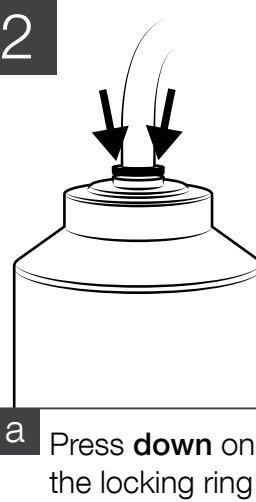

3

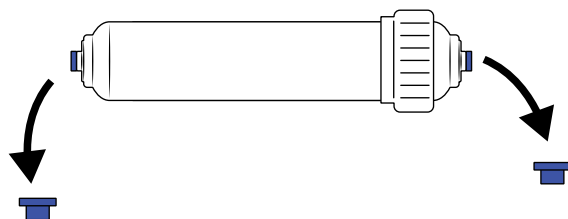

*Remove the Blue caps from both ends of the filter.

4

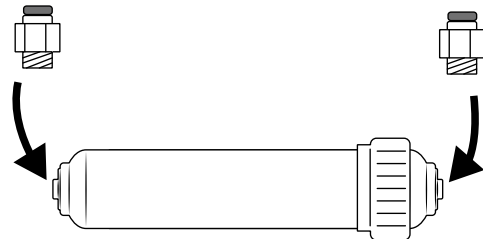

*Screw a threaded connector into each end of the filter.
Quarter turn with a spanner once hand-tight.

5

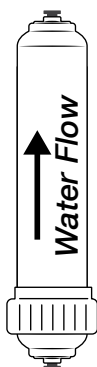

a Check the water flow direction
Cap to the base.

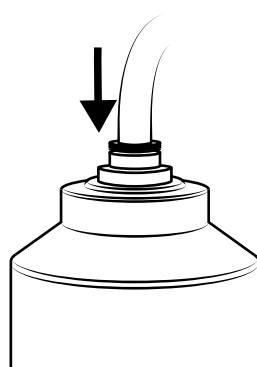

b Push fit the correct pipes into the filter

Once the new filter is installed

Connect the unit to a pressurized water source and check for any leaks.

* If a leak is found turn off the water supply and check connections.

! First Flush

The first flush of water from the unit will be **Black** in colour.

This is normal and will disappear after a few seconds of water flow from the unit.

FLOW METER - INSTRUCTIONS

Each MeetPAT unit is fitted with a digital flow meter. This is set to count up the amount of liters that have flowed through the unit.

This is important so you know when to change the carbon cartridge (if in the unit), when a service is due and to provide valuable marketing data.



1. LCD Display
2. Display Button
3. Reset Button

**The flow meter will automatically turn on when there is water flowing through the sensor.
It will automatically turn off in 10 seconds when there is no water flowing.*

Reading the Display

Press the “DISPLAY” button once to display real-time flow rate.

Press the “DISPLAY” button again to display the total liter count up.

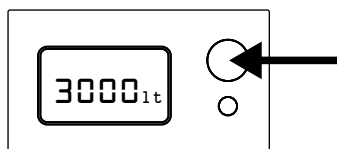

**The display will automatically turn off after a few seconds*

Re-Setting

Press the “DISPLAY” button and the “RESET” button together for 4 seconds.

The unit will beep once reset.

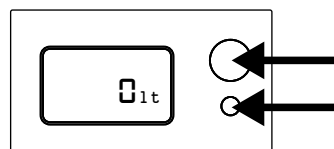

**The display will automatically turn off after a few seconds*

Beeping

When the battery is low, the buzzer will beep twice and the battery symbol blink to notify the user to change the battery.

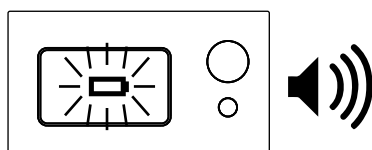

! Attention

1. Do not spray water into or around the flow meter.
2. Be-careful to not damage the wires when removing the flow meter.
3. For replacement parts and troubleshooting please contact MeetPAT.

FLOW METER - BATTERY CHANGE

! Record flow meter data

If still displayed, record the flow meter data.
Once the batteries are removed this data can be lost.

1 *Once a panel has been removed. Locate the flow meter inside the unit

I look like this

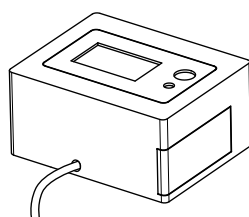

2

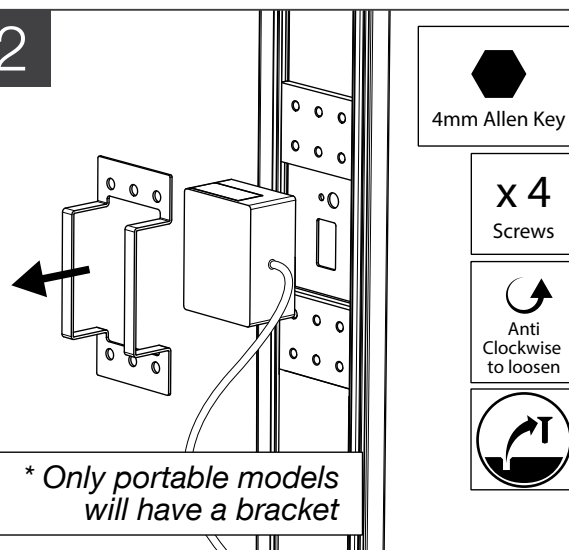

** Only portable models will have a bracket*

3

** Permanent model - flow meter lifts off bracket*

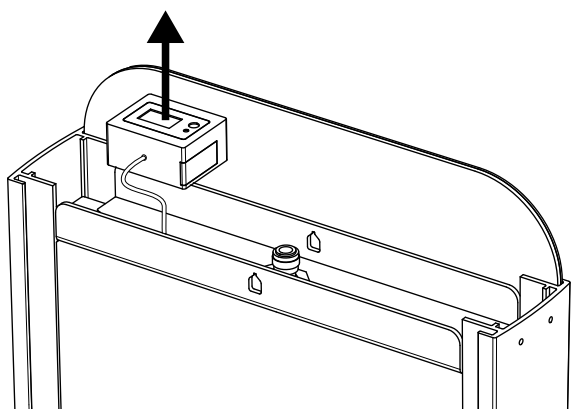

4

x 2

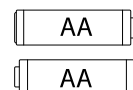

Once batteries are installed

Attach the flow meter back into place.
Check the unit is working by pressing the **display** button.

** If the display is not working check the battery positions and battery connections.*



Meet PAT™ | Products and Things Pty Ltd | meetpat.com.au
Head Office: 278 Townsend Street, Albury, NSW, 2640, Australia
Phone:(02)60210300,+61260210300Email:sales@meetpat.com.au

Meet PAT Limited NZ | meetpat.co.nz
12 Bethlehem Road, Bethlehem, Tauranga, 3100

All information and images contained in the document are © Meet PAT™ - Products and Things Pty Ltd (as a trustee for Meet Pat Unit Trust) or their respective owners. They are not be used without consent from Meet PAT™.

As improvements in the design and performance of Meet PAT products are continuous, specifications may be subject to change without notice. This technical sheet is copyright and owned by Meet PAT™ - Products and Things Pty Ltd (as a trustee for Meet Pat Unit Trust) ABN 42634465637. All rights are reserved. All products and sales are subject to Meet PAT™ terms and conditions.